

FIAT

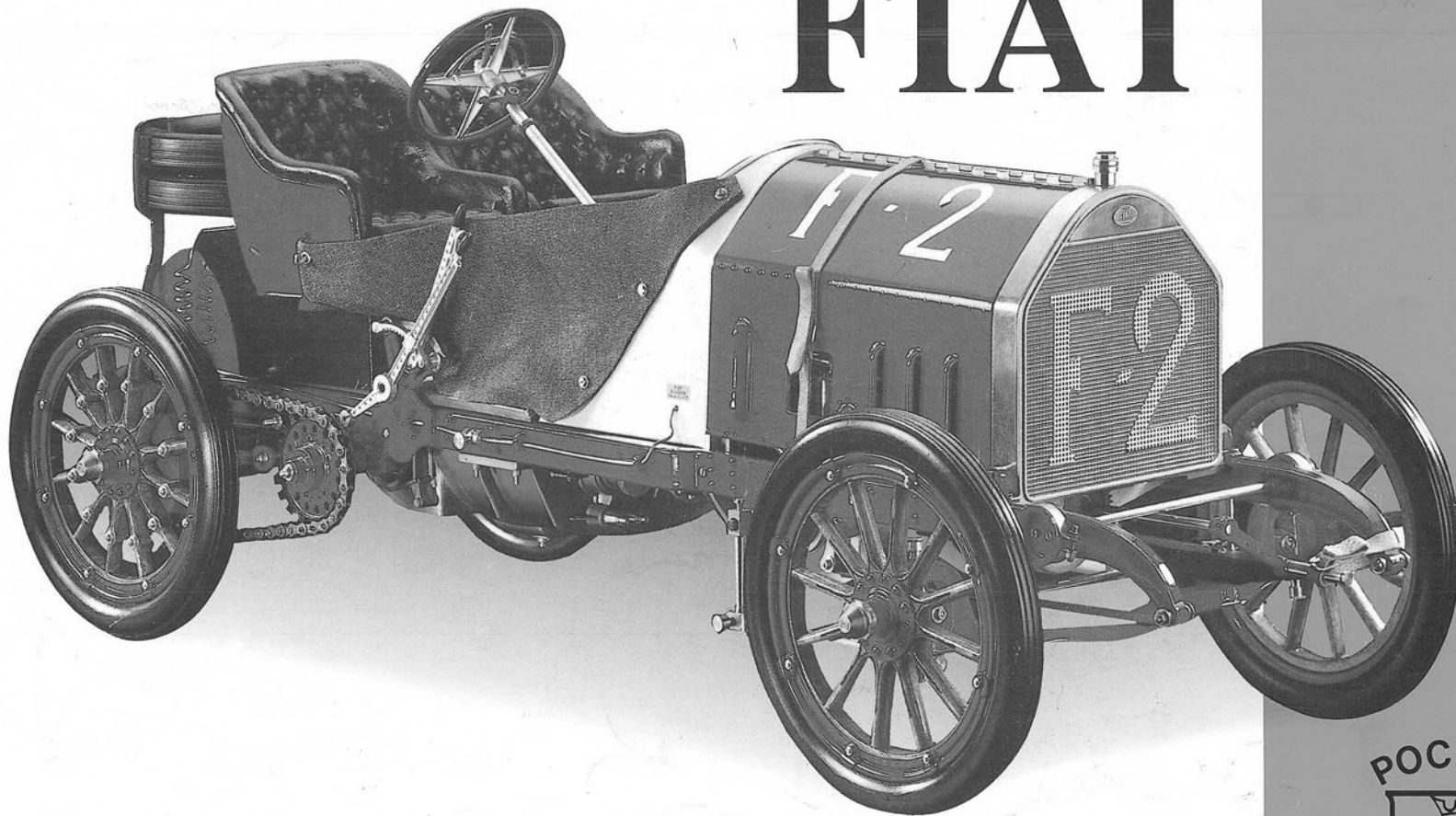

F-2 130 HP Racer 1907

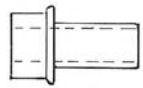



70110

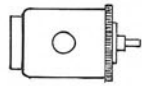

70130

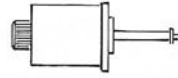

70140



70122

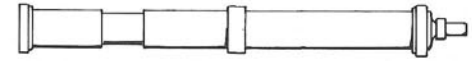

70260

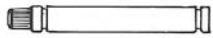

70125

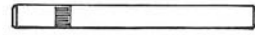

70113

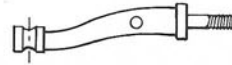

70119



70118

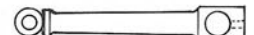

88107



70139



70133



70138



70137



70141

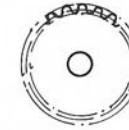

70309



88256



70129



88120



88126



70124



70132



70123



88134



88251



88252



70121



88300



70301



88323



88151



70302



72219



70307



70112



70253



70136



70131

SCALE 1:1

SCALE 1:1

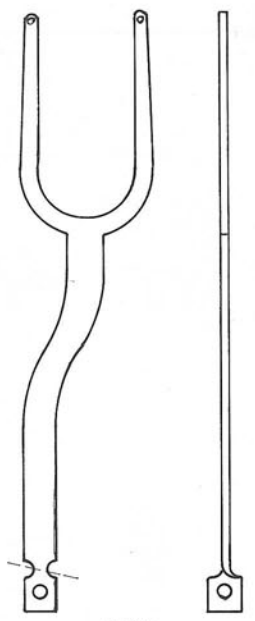

88001

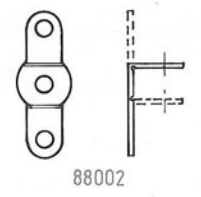

88002

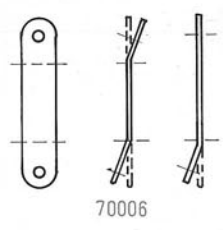

70006

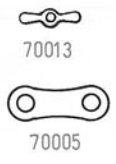

70013

70005



88003



70318



88067



70202

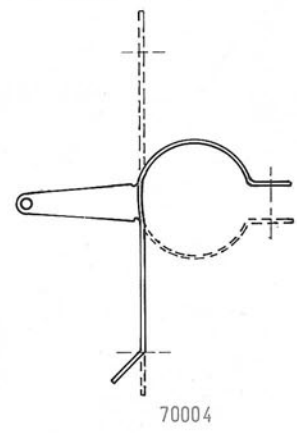

70004

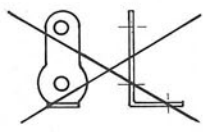

70008

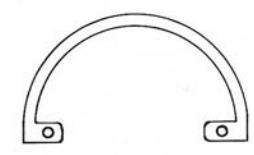

88004



70210

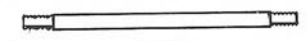

88209



70012

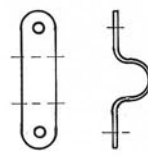

70007

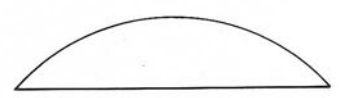

70003



70212



70011



70143



70207

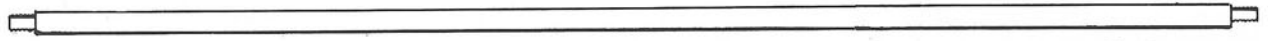

70144



70065

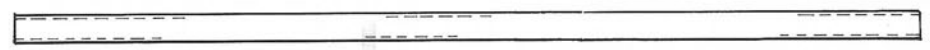

70146



70020

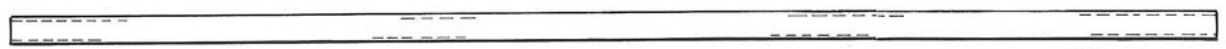

88145



88105



88016



88205



70213

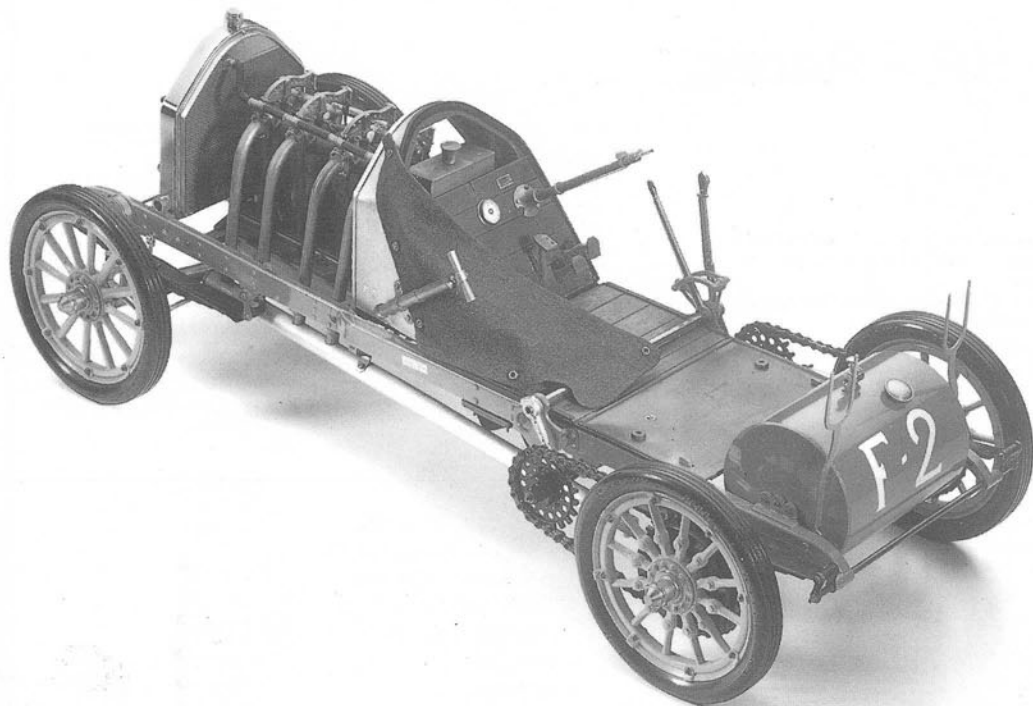

N.B. - Abbiamo previsto che alcuni pezzi possono guastarsi e perdersi durante il montaggio per inesperienza o disattenzione. Ne abbiamo quindi messo un discreto numero più del necessario per aiutarVi maggiormente.

N.B. - An extra quantity of some of the components has been provided to cover the possibility that some parts may be accidentally damaged or lost during assembly owing to inexperience.

N.B. - Er is een aantal onderdelen extra in de doos bijgevoegd voor het geval er iets zoekraakt of beschadigd wordt.

N.B. - Nous avons pensé que certaines pièces pourraient s'abîmer ou se perdre au cours du montage, à cause du manque d'expérience ou du manque d'attention. En conséquence, nous en avons mis un numéro plus important que celui normalement nécessaire afin de vous faciliter le travail.

N.B. - Es kann vorkommen, dass während der Montage irgend ein Teil unversehentlich beschädigt wird oder verloren geht. Um Ihnen in dieser Hinsicht behilflich zu sein, haben wir mehr Teile als für den Zusammenbau an sich notwendig ist beigegeben.

N.B. - Se proporcionan cantidades extras de algunos de los componentes por si se diera el caso de que, por falta de práctica, algunas de las piezas se dañaran accidentalmente o se perdieran durante el montaje.

OTTONE NATURALE
LAITON
BRASS
MESSING NATUR
LATÓN

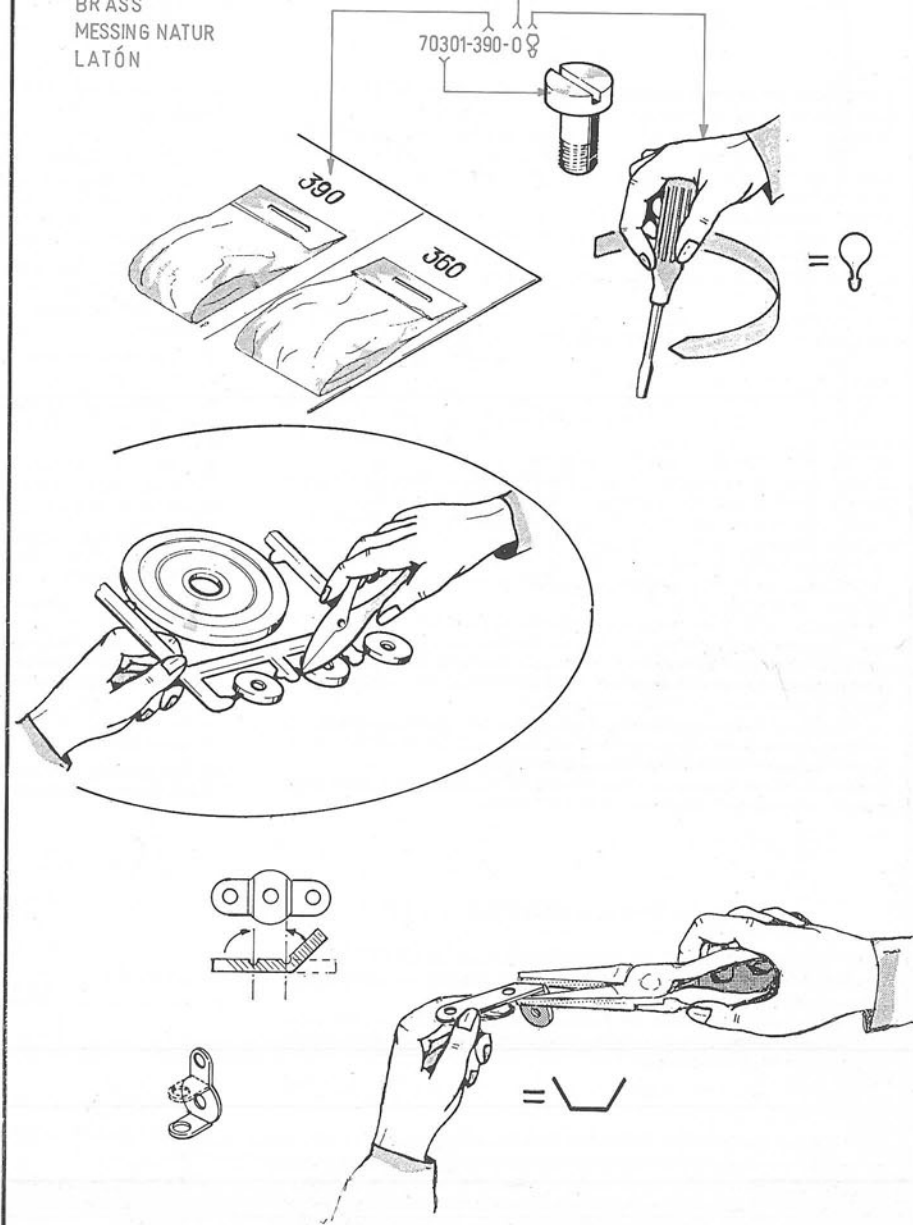

Fiat F2 130 HP - Racer 1907

D) We recommend keeping the contents of the envelopes separated at all times to prevent the loss or mixup of parts.

E) Proceed with the assembly systematically, starting with the major assemblies, but making sure not to leave off any minor part. We also suggest studying the «exploded views» on the drawings carefully before starting, in order to have a clear mental picture of the sequence of assembly steps.

F) Identify each part number and compare it to the numbers on the respective drawings. Then check the relative position of the parts.

G) The drawings are numbered 1 to 18. Some smaller parts are shown also in full scale (1:1) to make their identification easier. Rubber hoses, electrical cables, lubricating pipes, and the like, are furnished in single lengths. They must be cut to size according to the full scale diagrams as shown in the drawings.

H) To facilitate identification, every part is numbered according to the following scheme:

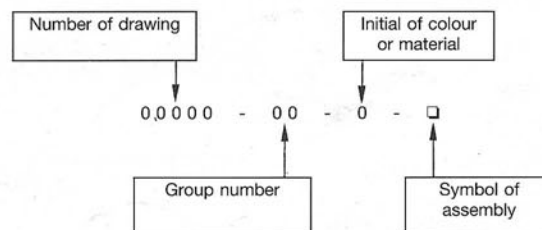

- Part Number in five digits identifies the part.
- Group of Parts in 2 or 3 digits is marked on the sprues carrying several plastic parts or on the envelopes containing parts.
- Material or Color is symbolized by capital letters according to the following code:

O = BRASS
 C = COPPER
 F = BLUED
 M = METALLIC GREY
 N = BLACK
 A = SILVER
 R = RED
 L = WOOD
 P = LEATHER
 G = RUBBER
 T = TRASPARENT

- Method of Assembly is indicated by symbols, as follows:

○ = THREADED BY HAND
 ⚙ = FASTENED WITH SCREWDRIVER

○ = FASTENED WITH SOCKET WRENCH
 ⚗ = FASTENED WITH OPEN WRENCH
 ⚒ = TAPPED WITH HAMMER
 ⚡ = SNAP FASTENED
 ⚧ = CEMENTED
 ⚒ = SELF-ADHESIVE
 ⚙ = FREE TO ROTATE
 ⚓ = TO THE BENT

(1) the plastic stud is softened by a heated screwdriver or small soldering iron and then flared to lock the parts together.

- I)** We suggest assembling the model in stages, as follows:
- 1) Assemble the engine, including all its parts, as shown in drawing 1.
 - 2) Assemble the radiator as per drawing 5
 - 3) Assemble the steering mechanism and the other sub-assemblies shown in drawing 3
 - 4) Assemble part of the chassis according to drawings 12
 - 5) Complete the chassis assembly according to drawings 13 - 15 - 17
 - 6) Assemble the rear brakes, the hand brake (drawing 8), as shown in drawing 14
 - 7) Assemble the chains according to drawings 16-17-18

After having completed the assembly according to the instructions, you will end up with an attractive and valuable model. However, it should not be painted carelessly.

We recommend to those who are experienced, pre-painting the plastic parts using synthetic spray paints or enamels. It is emphasized again, that under no circumstances, should nitrocellulose lacquers or airplane dope be applied because these would ruin the model irretrievably.

We trust that the assembly of this model was enjoyable. If so, we have accomplished our aim to provide a pleasurable hobby and, at the same time, a top-notch model of a vintage car.

ASSEMBLY INSTRUCTIONS

Follow the drawings carefully in order to do justice to the model

- The assembly is simple, and requires only scissors, tweezers, shears or cutting pliers, a small file, and a screwdriver.
- A small wrench (72222) is furnished in the kit, to be used for fastening the small brass nuts (70321).
- Drawings numbered 1 through 18, clearly show the proper sequence of assembly.

A) All parts are furnished in appropriate colors. However, a more realistic appearance results if the plastic parts are painted over. We recommend the use of synthetic paints sold in model shops. Best finish is obtained with spray paints. DO NOT USE NITROCELLULOSE PAINTS.

B) If metal parts show signs of tarnish due to oxidation or fingerprints, remove these with an ordinary household metal cleaning compound. Then coat the parts with transparent lacquer for more permanent protection.

C) All parts are numbered whenever possible. Where numbering was impracticable, the parts are packed in transparent envelopes. A list of part number and quantity is then imprinted on, or next to, the envelopes.

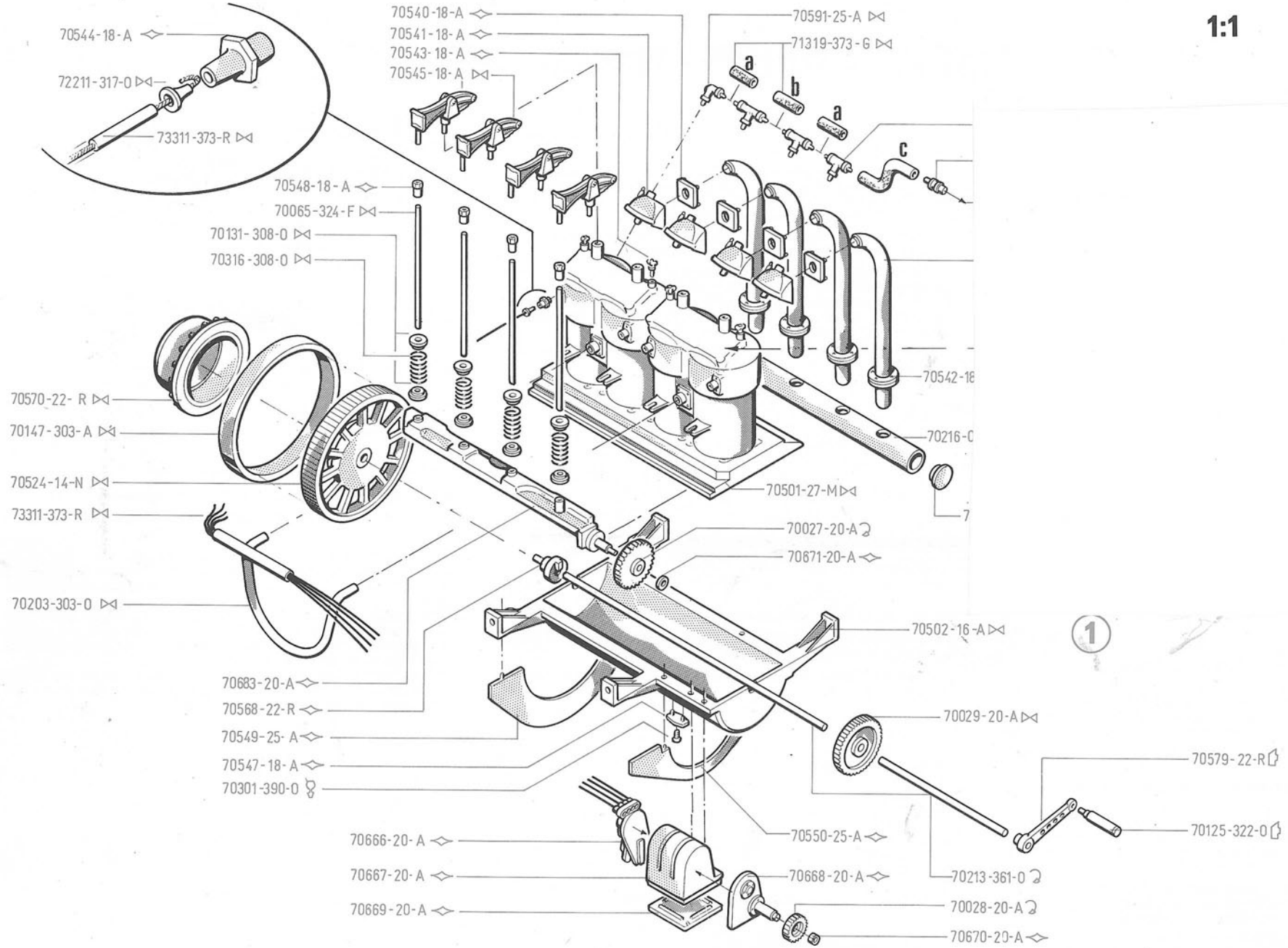

1:1



1

70544-18-A

72211-317-0

73311-373-R

70540-18-A

70541-18-A

70543-18-A

70545-18-A

70591-25-A

71319-373-G

70548-18-A

70065-324-F

70131-308-0

70316-308-0

70570-22-R

70147-303-A

70524-14-N

73311-373-R

70203-303-0

70683-20-A

70568-22-R

70549-25-A

70547-18-A

70301-390-0

70666-20-A

70667-20-A

70669-20-A

70501-27-M

70027-20-A

70671-20-A

70542-18

70216-0

70502-16-A

70029-20-A

70550-25-A

70668-20-A

70670-20-A

70579-22-R

70125-322-0

70213-361-0

70028-20-A

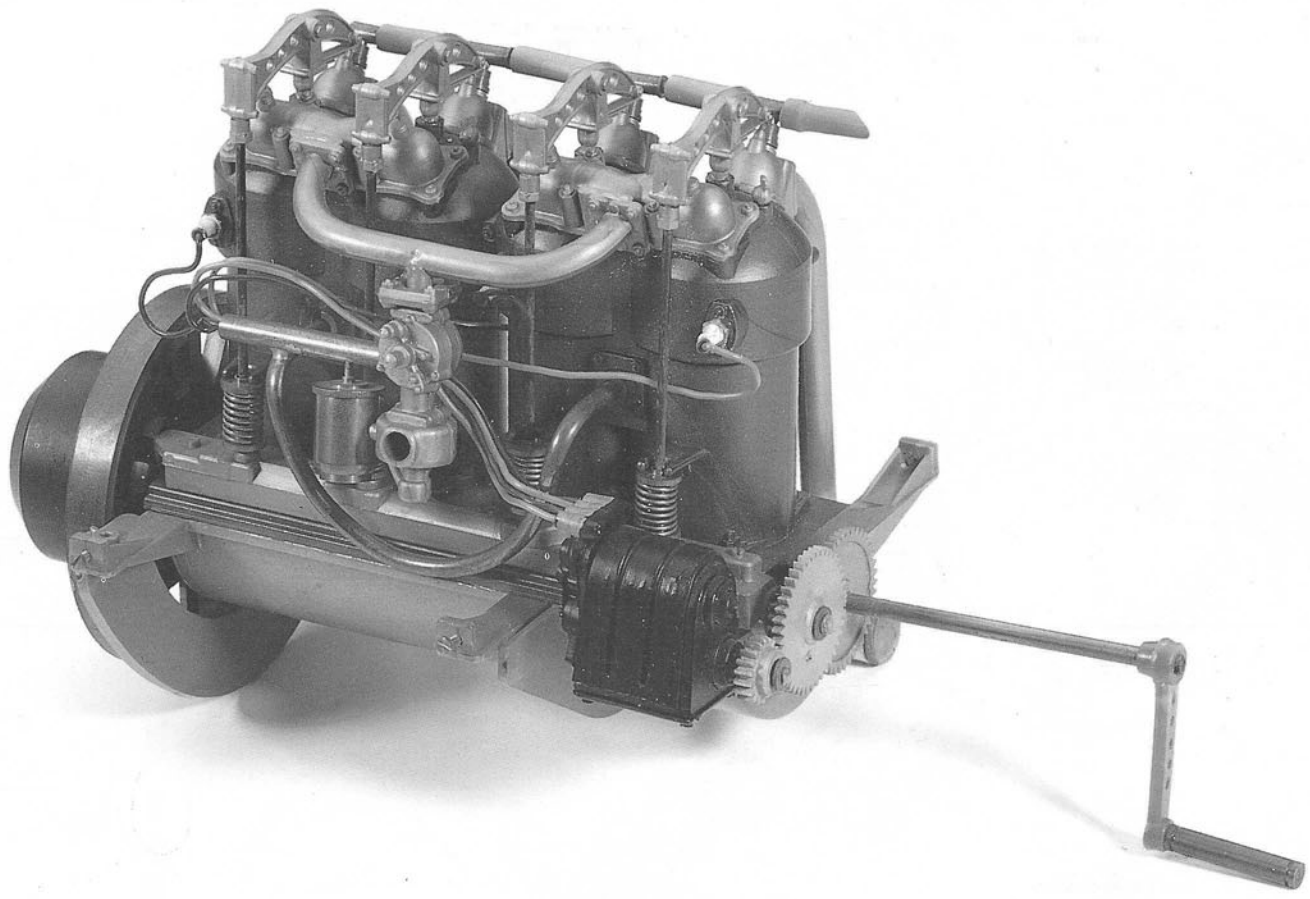

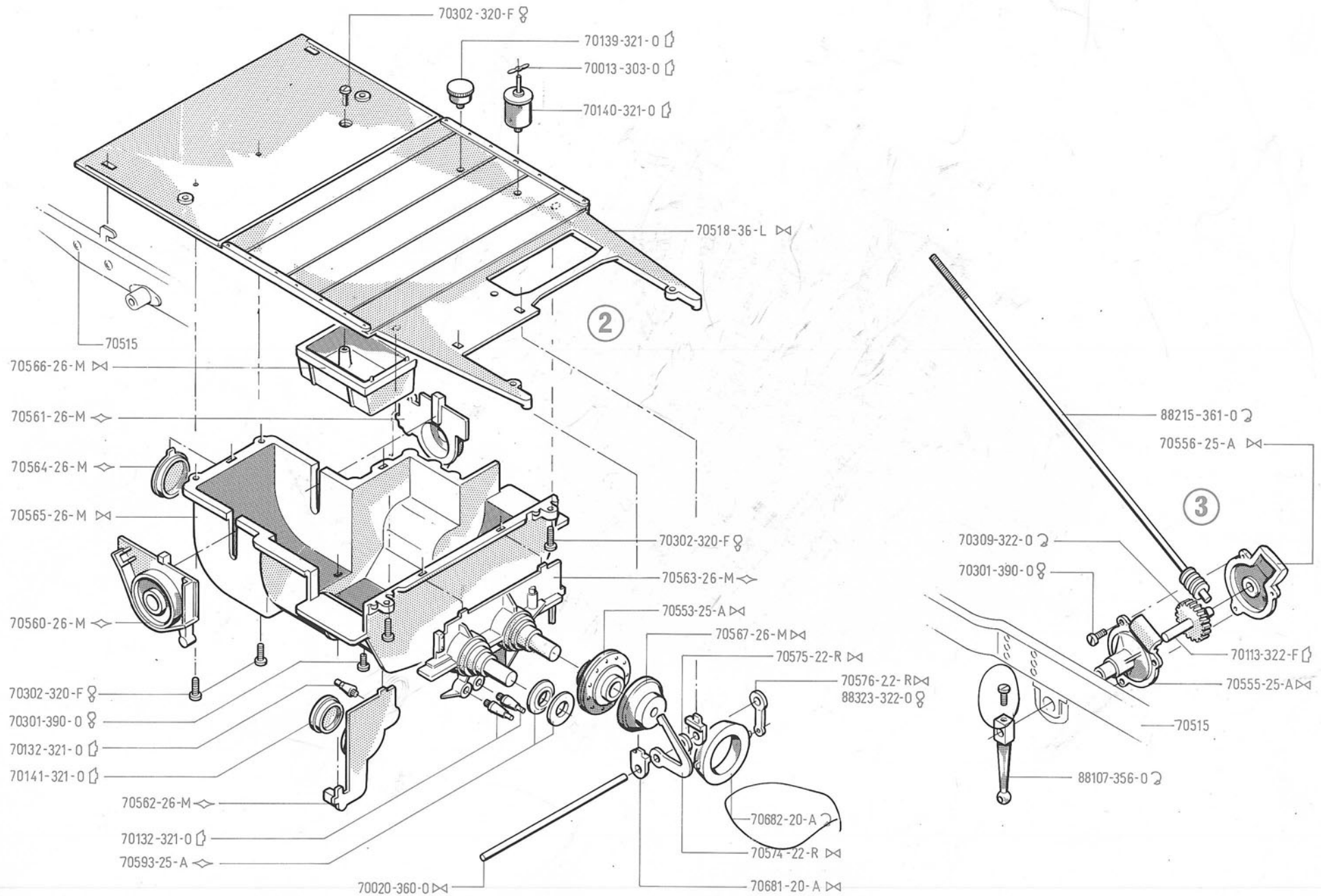

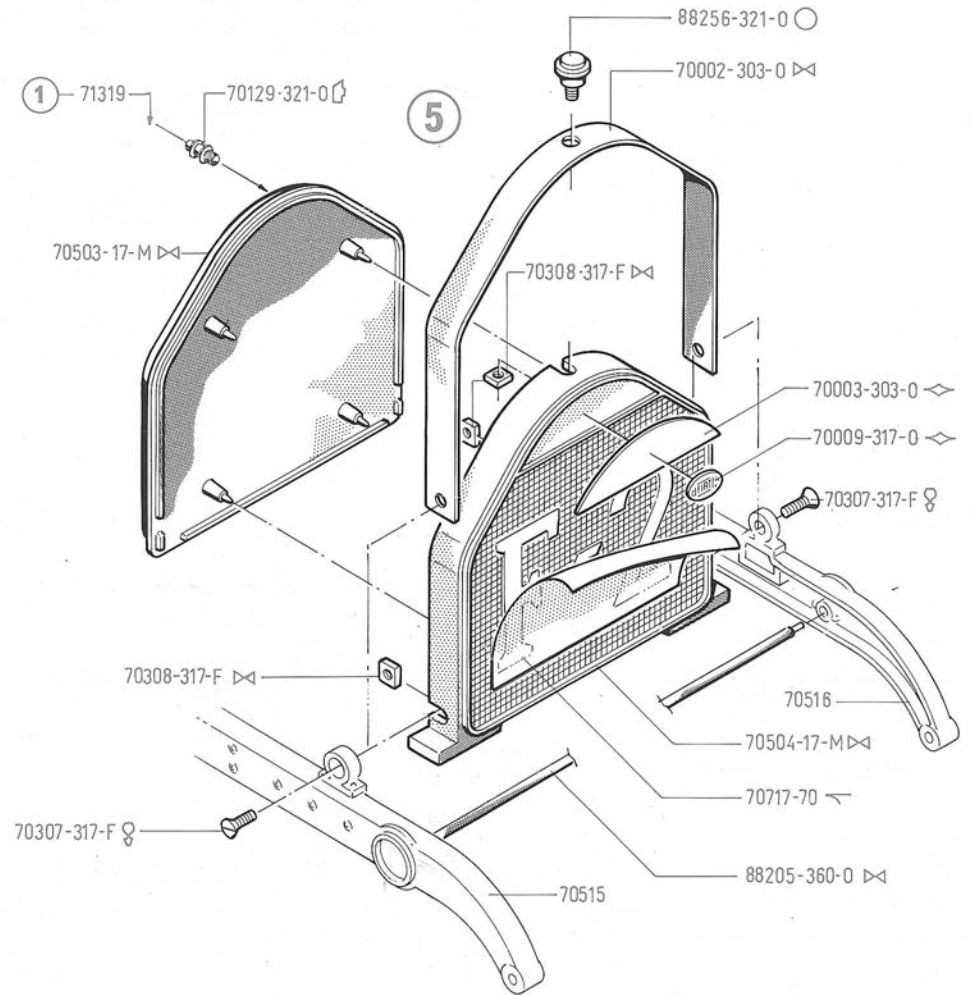
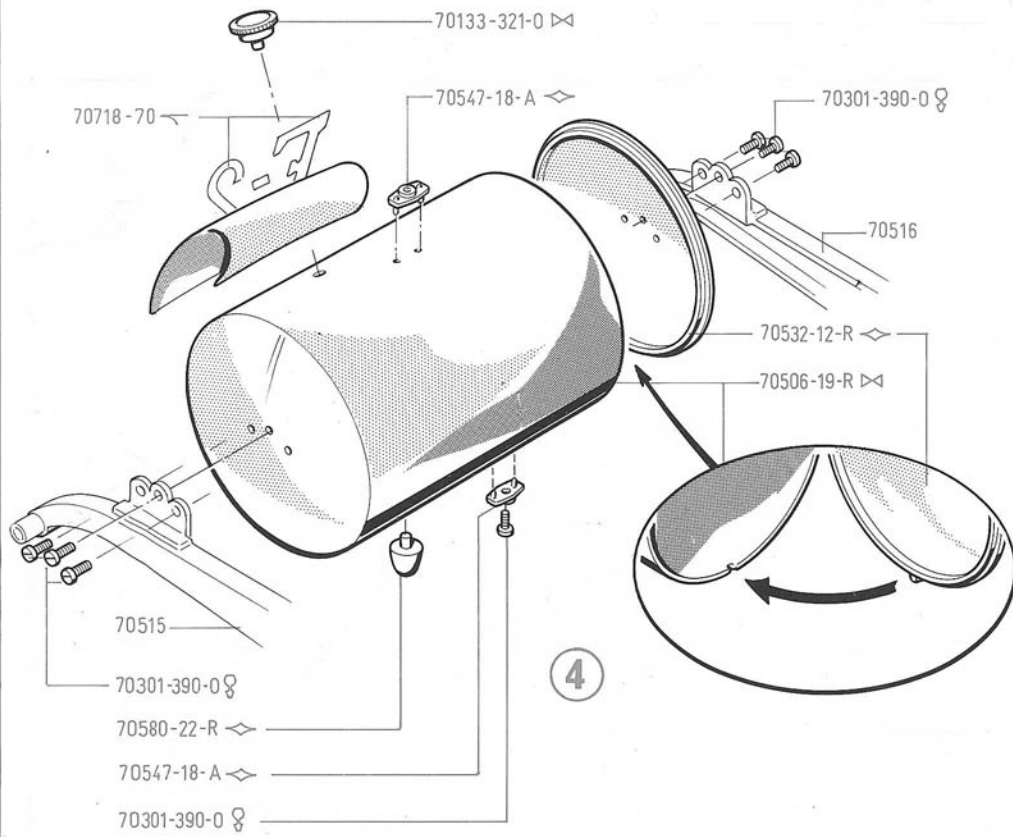

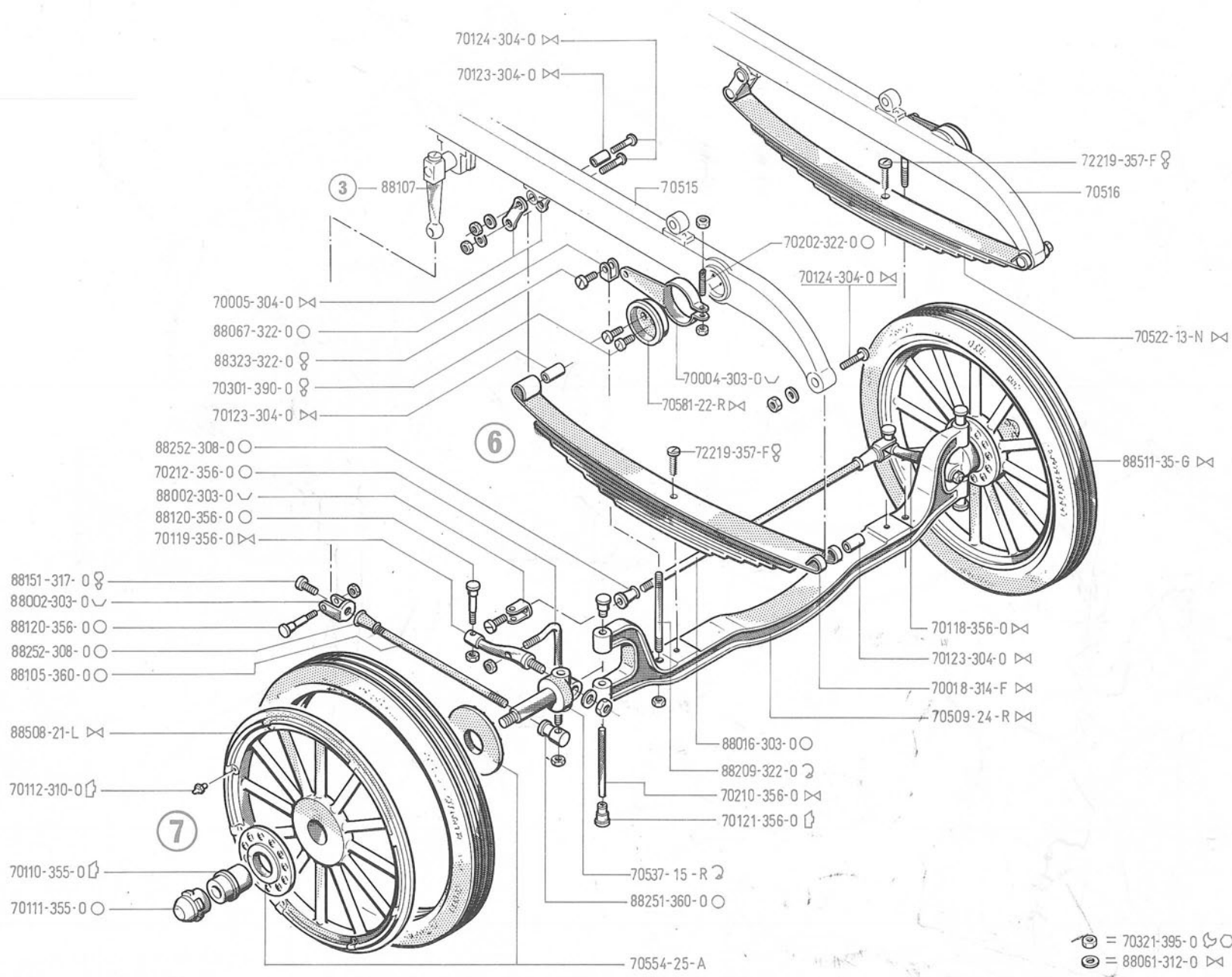

⊕ = 70321-395-0 ⊕ ⊕
 ⊕ = 88061-312-0 ⊕

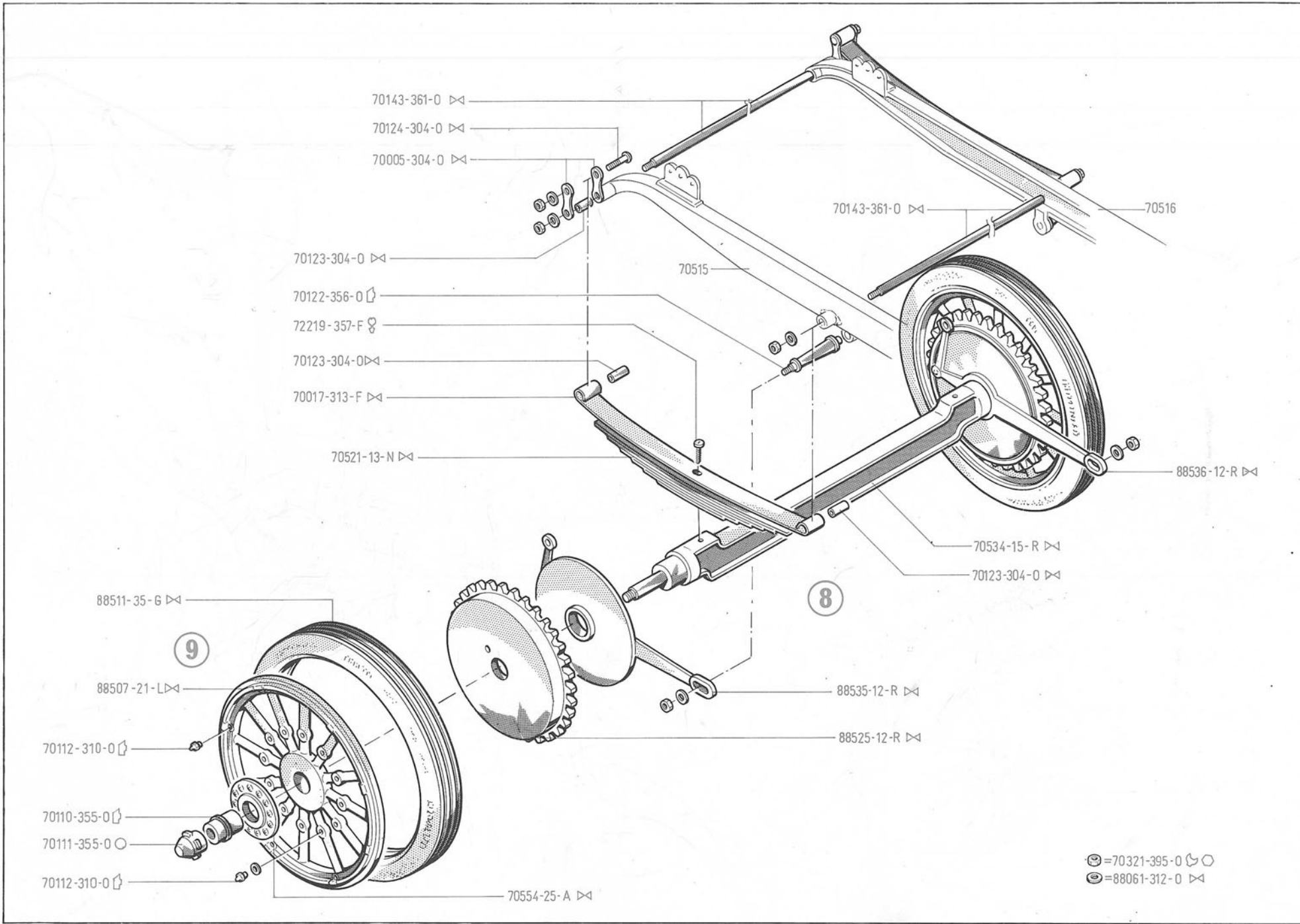

70143-361-0 ∆
 70124-304-0 ∆
 70005-304-0 ∆

70143-361-0 ∆ 70516

70123-304-0 ∆
 70122-356-0 ◻
 72219-357-F ◻
 70123-304-0 ∆
 70017-313-F ∆

70515

70521-13-N ∆

88536-12-R ∆

70534-15-R ∆
 70123-304-0 ∆

8

88511-35-G ∆

9

88507-21-L ∆

88535-12-R ∆

70112-310-0 ◻

88525-12-R ∆

70110-355-0 ◻

70111-355-0 ○

70112-310-0 ◻

70554-25-A ∆

◻ = 70321-395-0 ◻
 ○ = 88061-312-0 ∆

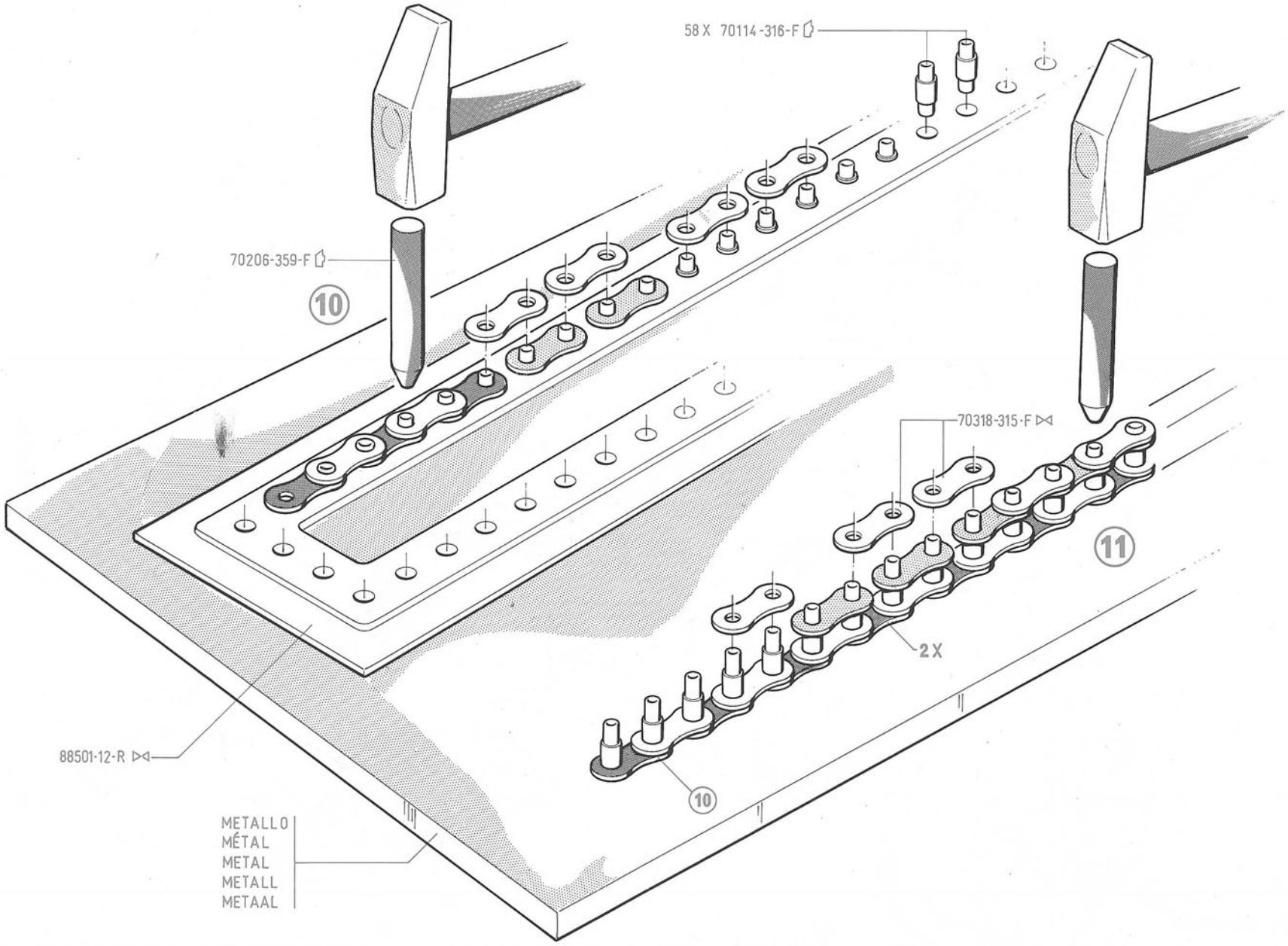

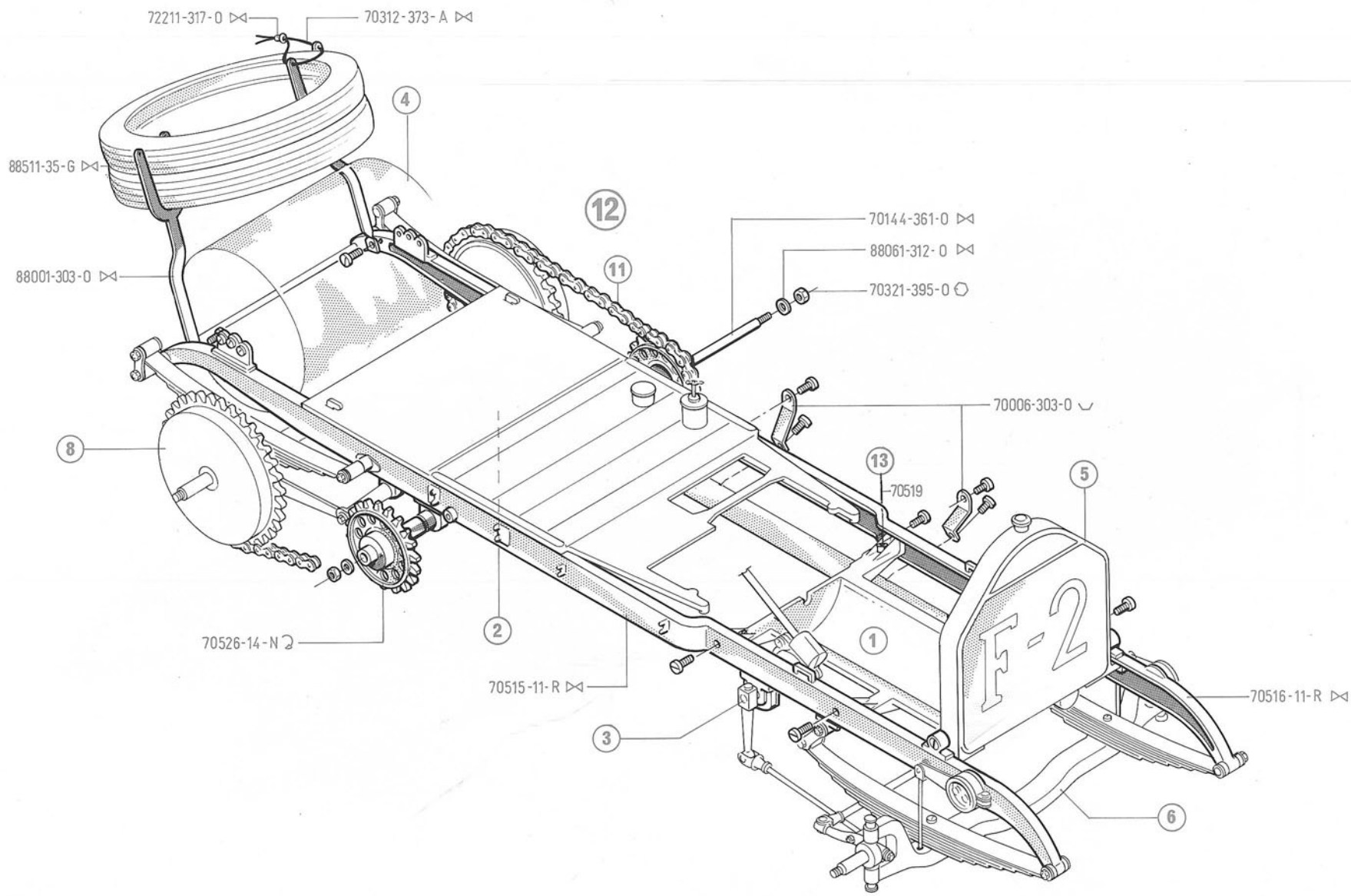

 = 70301-390-0

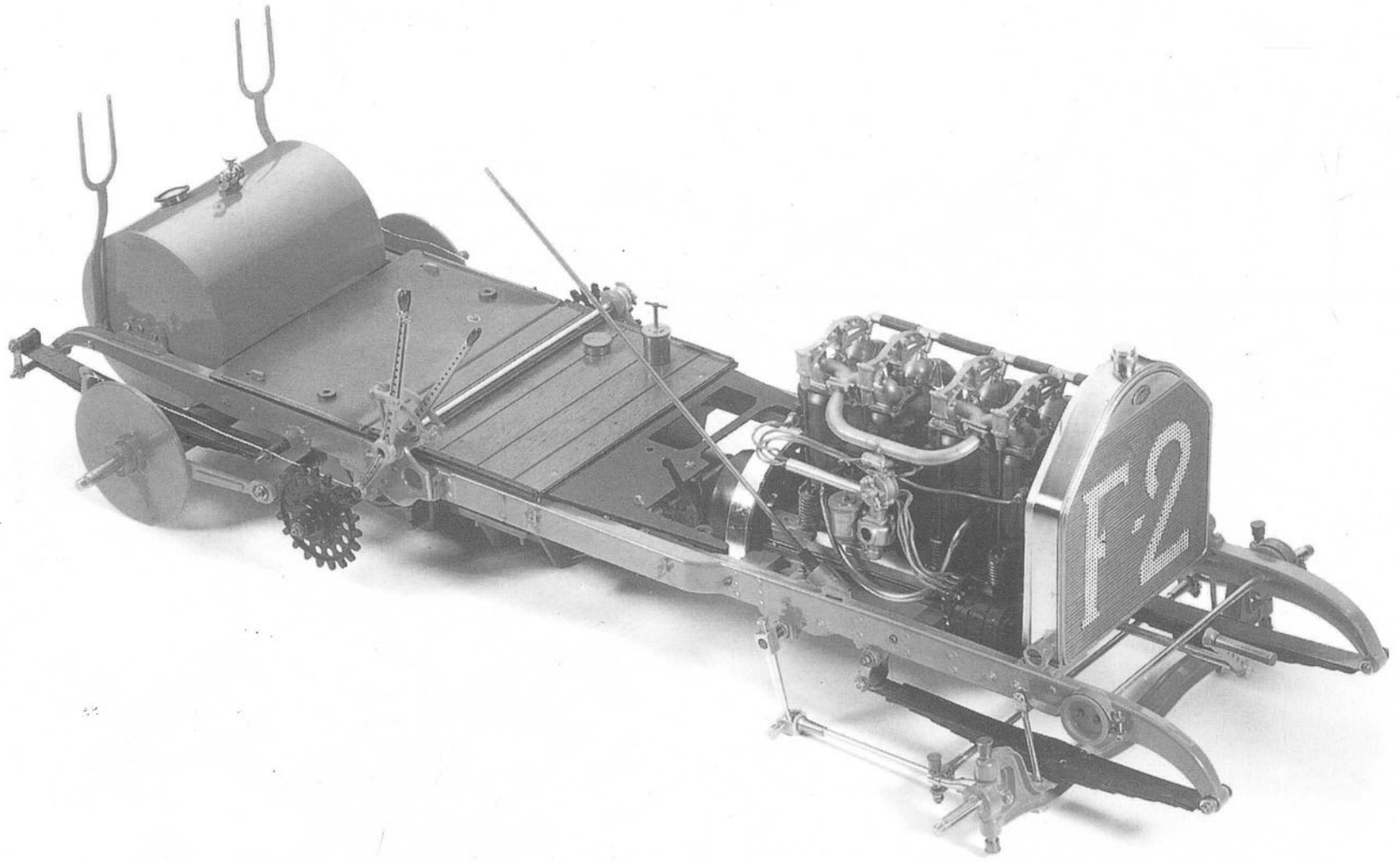

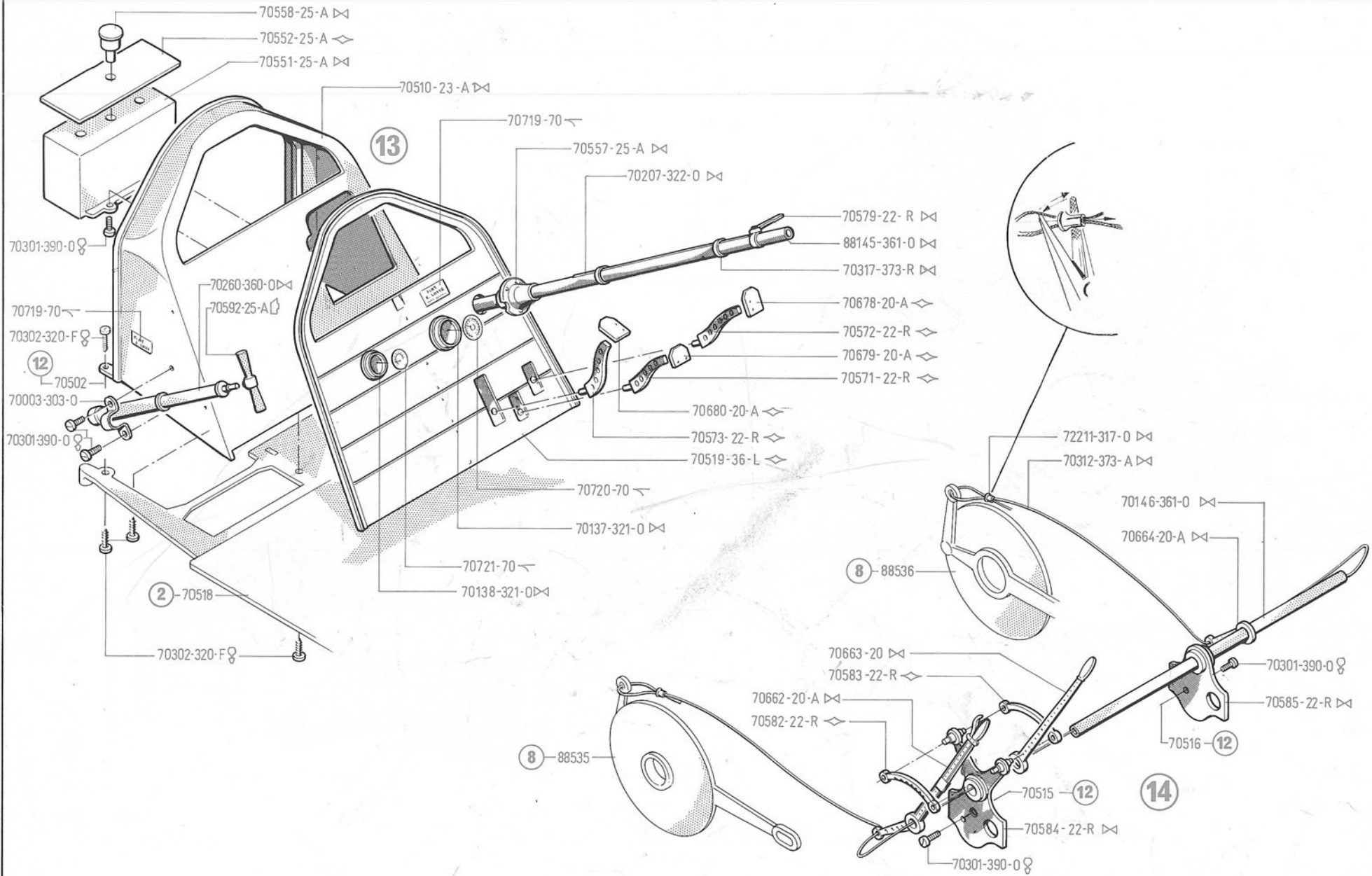

15

88506-29-N

88505-29-R

70313-323-0

70578-22-R

70530-28-N

70531-28-N

70313-323-0

70577-22-R

70302-320-F

2-70518

70528-43-R

88717-70

16

70019-360-0

88300-357-0

70529-43-R

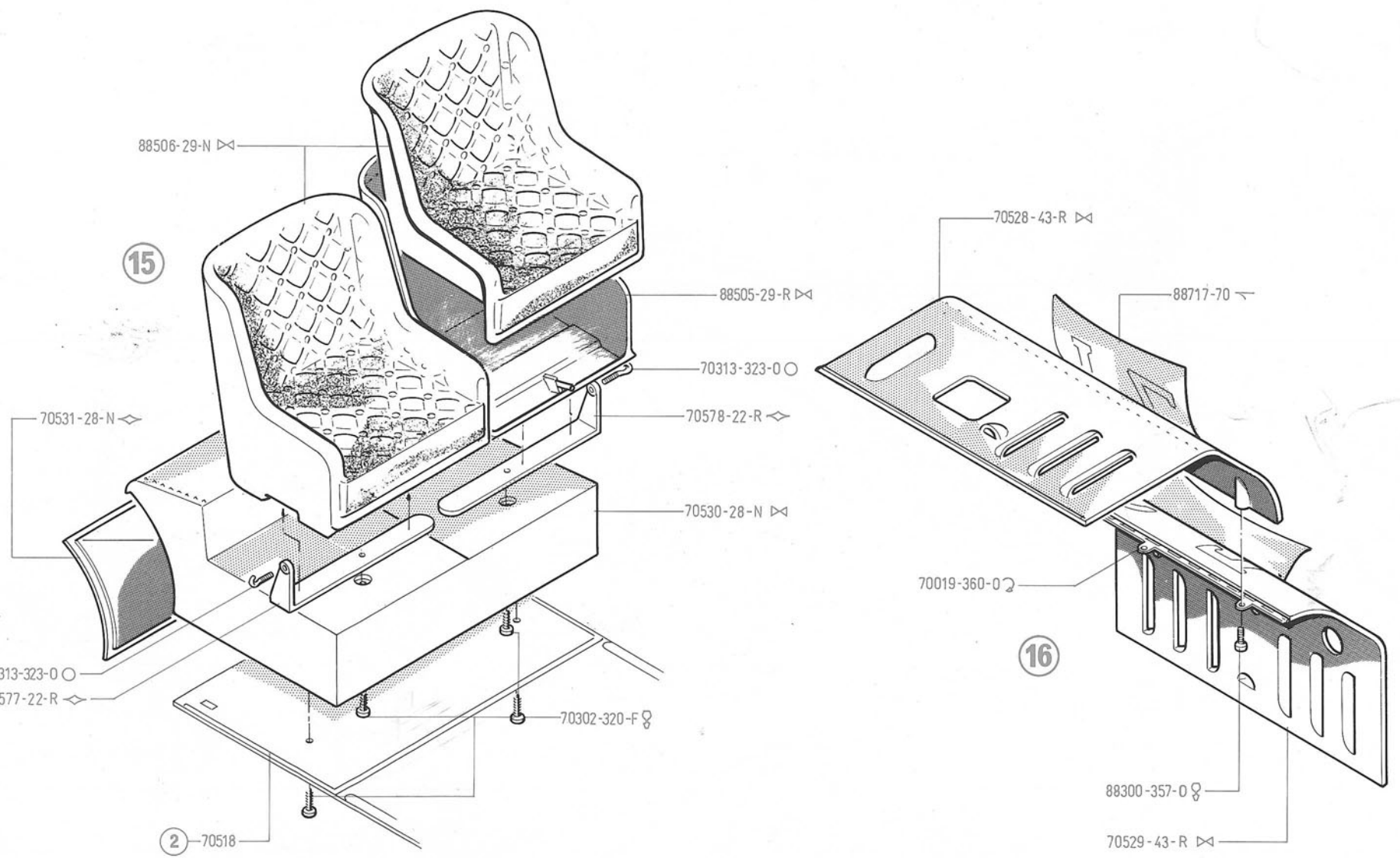

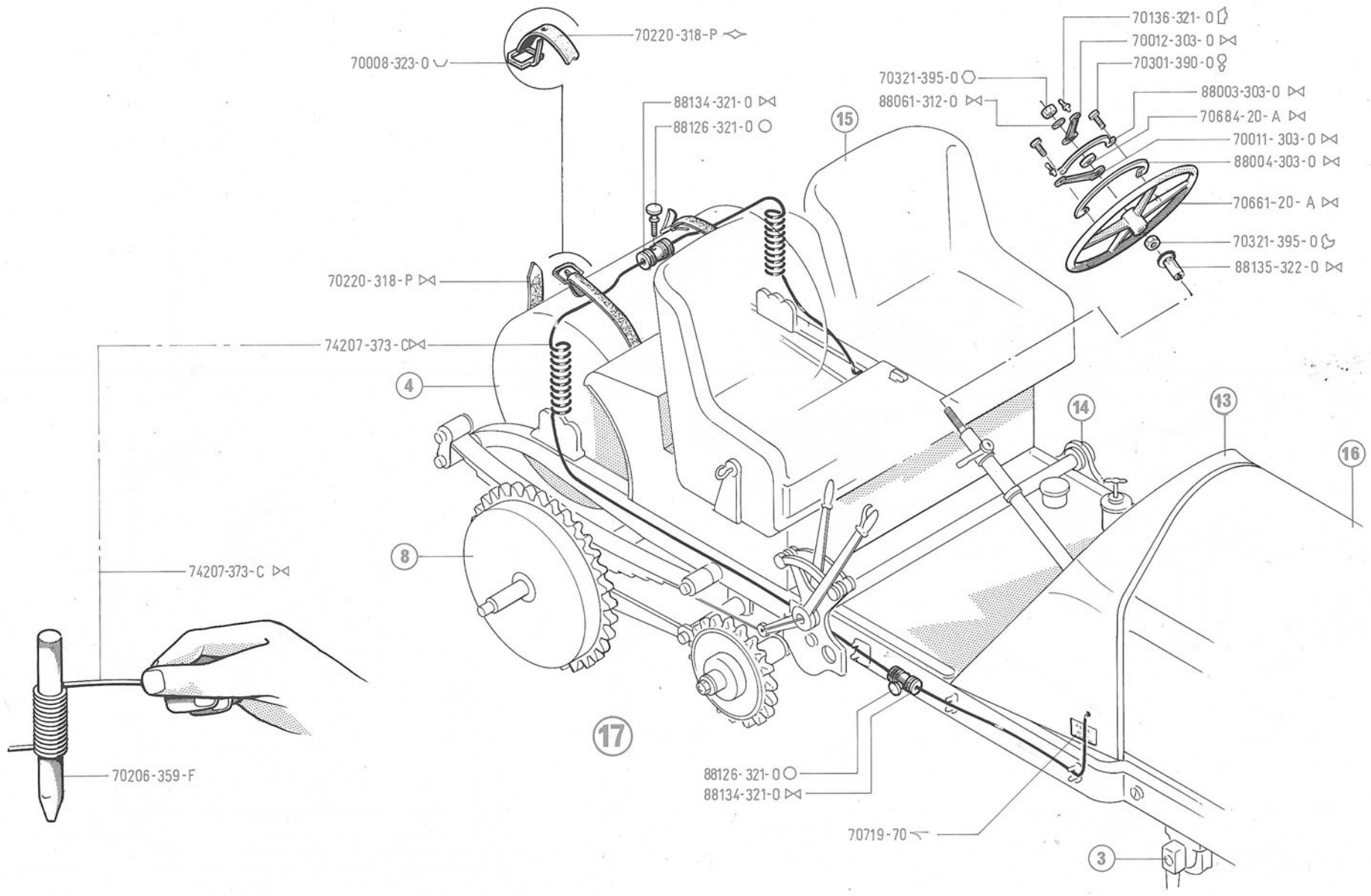

1:1	70223	70223	70222
70220	318 P		
70220			
70221			

18

